

A46 Newark Bypass

TR010065/APP/2.6

2.6 Engineering Plans and Sections Part 1 – Typical Cross Sections

APFP Regulation 5(2)(o), 5(2)(p) and 6(2)

Planning Act 2008

Infrastructure Planning (Applications: Prescribed Forms and
Procedure) Regulations 2009

Volume 2

April 2024

Infrastructure Planning

Planning Act 2008

**The Infrastructure Planning
(Applications: Prescribed Forms
and Procedure) Regulations 2009**

A46 Newark Bypass

Development Consent Order 202[x]

Engineering Plans and Sections

Part 1 – Typical Cross Sections

Regulation Number:	Regulation 5(2)(o), 5(2)(p) and 6(2)
Planning Inspectorate Scheme Reference	TR010065
Application Document Reference	TR010065/APP/2.6
Author:	A46 Newark Bypass Project Team, National Highways

Version	Date	Status of Version
Rev 1	April 2024	DCO Application

Contents

1	Introduction	2
1.1	General.....	2
2	Schedule of Plans Included in this Application Document	3

1 Introduction

1.1 General

1.1.1 These Engineering Plans and Sections (these “Plans”) relate to an application made by National Highways (the “Applicant”) to the Secretary of State for Transport via the Planning Inspectorate (the “Inspectorate”) under the Planning Act 2008 (the “2008 Act”) for a Development Consent Order (DCO). If made, the DCO would grant consent for the A46 Newark Bypass (the “Scheme”). A detailed description of the Scheme can be found in Chapter 2 (The Scheme) of the Environmental Statement (ES) (TR010065/APP/6.1).

1.1.2 These Plans forms part of a suite of application documents and is included in the application in compliance with Regulation 5(2)(o), 5(2)(p) and 6(2) of the Infrastructure Planning (Prescribed Forms and Procedure) Regulations 2009 (the “2009 Regulations”) which requires:

‘5(2)(o) any other plans, drawings and sections necessary to describe the proposals for which development consent is sought, showing details of design, external appearance, and the preferred layout of buildings or structures, drainage, surface water management, means of vehicular and pedestrian access, any car parking to be provided, and means of landscaping’.

...

‘5(2)(p) any of the documents prescribed by Regulation 6 which are relevant to the particular project’

...

‘6(2) if the application is for highway related development or for the construction or alteration of a railway, it must be accompanied by section drawings to suitable horizontal and vertical scales which show, by reference to Ordnance Survey or Chart datum –

(a) The levels of the proposed works, including in particular and where relevant

(i) ground levels;

(ii) the height of every proposed bridge, viaduct, aqueduct embankment and elevated guideway;

(iii) the depth of every proposed cutting and tunnel;

(iv) the levels of the bed of any tidal waters or inland waterway in which it is proposed that any works should be situated;

(v) the height of every structure or device (including a cable, but not catenary and related equipment) intended to be erected above, on or below the surface of, or on or beneath the bed of tidal water or an inland waterway; and

(vi) drainage outfall details for highways;

(b) a cross section of every intended tunnel and any altered gradient of a carriageway or a way forming part of a guided transport system on either

side of every level crossing, bridge, tunnel or underpass which would carry the carriageway or way through which it would pass’.

- 1.1.3 As these Plans are part of the application documentation they should be read alongside and are informed by the other application documents, in particular the draft DCO (TR010065/APP/3.1), the Works Plans (TR010065/APP/2.3) and the General Arrangement Plans (TR010065/APP/2.5).

2 Schedule of Plans Included in this Application Document

Drawing Number	Drawing Title	Version
PART 1 – TYPICAL CROSS SECTIONS		
HE551478-SKAG-HGN-CONWI_CONW-DR-CH-26100	Typical Cross Sections – Key Plan	C02
HE551478-SKAG-HGN-CONWI_CONW-DR-CH-26106	Typical Cross Sections – Sheet 1 of 4	C02
HE551478-SKAG-HGN-CONWI_CONW-DR-CH-26107	Typical Cross Sections – Sheet 2 of 4	C02
HE551478-SKAG-HGN-CONWI_CONW-DR-CH-26108	Typical Cross Sections – Sheet 3 of 4	C02
HE551478-SKAG-HGN-CONWI_CONW-DR-CH-26109	Typical Cross Sections – Sheet 4 of 4	C02
PART 2 – PLAN AND PROFILES		
HE551478-SKAG-HGN-CONWI_CONW-DR-CH-26200	Plan and Profiles – Key Plan	C02
HE551478-SKAG-HGN-CONWI_CONW-DR-CH-26201	Plan and Profiles – Sheet 1 of 37	C02
HE551478-SKAG-HGN-CONWI_CONW-DR-CH-26202	Plan and Profiles – Sheet 2 of 37	C02
HE551478-SKAG-HGN-CONWI_CONW-DR-CH-26203	Plan and Profiles – Sheet 3 of 37	C02
HE551478-SKAG-HGN-CONWI_CONW-DR-CH-26204	Plan and Profiles – Sheet 4 of 37	C02
HE551478-SKAG-HGN-CONWI_CONW-DR-CH-26205	Plan and Profiles – Sheet 5 of 37	C02
HE551478-SKAG-HGN-CONWI_CONW-DR-CH-26206	Plan and Profiles – Sheet 6 of 37	C02
HE551478-SKAG-HGN-CONWI_CONW-DR-CH-26207	Plan and Profiles – Sheet 7 of 37	C02

HE551478-SKAG-HGN-CONWI_CONW-DR-CH-26208	Plan and Profiles – Sheet 8 of 37	C02
HE551478-SKAG-HGN-CONWI_CONW-DR-CH-26209	Plan and Profiles – Sheet 9 of 37	C02
HE551478-SKAG-HGN-CONWI_CONW-DR-CH-26210	Plan and Profiles – Sheet 10 of 37	C02
PART 3 – PLAN AND PROFILES		
HE551478-SKAG-HGN-CONWI_CONW-DR-CH-26220	Plan and Profiles – Sheet 11 of 37	C02
HE551478-SKAG-HGN-CONWI_CONW-DR-CH-26230	Plan and Profiles – Sheet 12 of 37	C02
HE551478-SKAG-HGN-CONWI_CONW-DR-CH-26231	Plan and Profiles – Sheet 13 of 37	C02
HE551478-SKAG-HGN-CONWI_CONW-DR-CH-26232	Plan and Profiles – Sheet 14 of 37	C02
HE551478-SKAG-HGN-CONWI_CONW-DR-CH-26233	Plan and Profiles – Sheet 15 of 37	C02
HE551478-SKAG-HGN-CONWI_CONW-DR-CH-26240	Plan and Profiles – Sheet 16 of 37	C02
HE551478-SKAG-HGN-CONWI_CONW-DR-CH-26241	Plan and Profiles – Sheet 17 of 37	C02
HE551478-SKAG-HGN-CONWI_CONW-DR-CH-26242	Plan and Profiles – Sheet 18 of 37	C02
HE551478-SKAG-HGN-CONWI_CONW-DR-CH-26250	Plan and Profiles – Sheet 19 of 37	C02
HE551478-SKAG-HGN-CONWI_CONW-DR-CH-26260	Plan and Profiles – Sheet 20 of 37	C02
HE551478-SKAG-HGN-CONWI_CONW-DR-CH-26261	Plan and Profiles – Sheet 21 of 37	C02
HE551478-SKAG-HGN-CONWI_CONW-DR-CH-26262	Plan and Profiles – Sheet 22 of 37	C02
HE551478-SKAG-HGN-CONWI_CONW-DR-CH-26263	Plan and Profiles – Sheet 23 of 37	C02
HE551478-SKAG-HGN-CONWI_CONW-DR-CH-26270	Plan and Profiles – Sheet 24 of 37	C02
HE551478-SKAG-HGN-CONWI_CONW-DR-CH-26271	Plan and Profiles – Sheet 25 of 37	C02
PART 4 – PLAN AND PROFILES		
HE551478-SKAG-HGN-CONWI_CONW-DR-CH-26280	Plan and Profiles – Sheet 26 of 37	C02
HE551478-SKAG-HGN-CONWI_CONW-DR-CH-26281	Plan and Profiles – Sheet 27 of 37	C02

HE551478-SKAG-HGN-CONWI_CONW-DR-CH-26282	Plan and Profiles – Sheet 28 of 37	C02
HE551478-SKAG-HGN-CONWI_CONW-DR-CH-26283	Plan and Profiles – Sheet 29 of 37	C02
HE551478-SKAG-HGN-CONWI_CONW-DR-CH-26284	Plan and Profiles – Sheet 30 of 37	C02
HE551478-SKAG-HGN-CONWI_CONW-DR-CH-26285	Plan and Profiles – Sheet 31 of 37	C02
HE551478-SKAG-HGN-CONWI_CONW-DR-CH-26286	Plan and Profiles – Sheet 32 of 37	C02
HE551478-SKAG-HGN-CONWI_CONW-DR-CH-26287	Plan and Profiles – Sheet 33 of 37	C02
HE551478-SKAG-HGN-CONWI_CONW-DR-CH-26288	Plan and Profiles – Sheet 34 of 37	C02
HE551478-SKAG-HGN-CONWI_CONW-DR-CH-26289	Plan and Profiles – Sheet 35 of 37	C02
HE551478-SKAG-HGN-CONWI_CONW-DR-CH-26290	Plan and Profiles – Sheet 36 of 37	C02
HE551478-SKAG-HGN-CONWI_CONW-DR-CH-26291	Plan and Profiles – Sheet 37 of 37	C02
PART 5 – DRAINAGE ENGINEERING PLANS		
HE551478-SKAG-HDG-CONWI_CONW-DR-CD-26300	Drainage Engineering Plans – Key Plan	C02
HE551478-SKAG-HDG-CONWI_CONW-DR-CD-26301	Drainage Engineering Plans – Sheet 1 of 7	C02
HE551478-SKAG-HDG-CONWI_CONW-DR-CD-26302	Drainage Engineering Plans – Sheet 2 of 7	C02
HE551478-SKAG-HDG-CONWI_CONW-DR-CD-26303	Drainage Engineering Plans – Sheet 3 of 7	C02
HE551478-SKAG-HDG-CONWI_CONW-DR-CD-26304	Drainage Engineering Plans – Sheet 4 of 7	C02
HE551478-SKAG-HDG-CONWI_CONW-DR-CD-26305	Drainage Engineering Plans – Sheet 5 of 7	C02
HE551478-SKAG-HDG-CONWI_CONW-DR-CD-26306	Drainage Engineering Plans – Sheet 6 of 7	C02
HE551478-SKAG-HDG-CONWI_CONW-DR-CD-26307	Drainage Engineering Plans – Sheet 7 of 7	C02
PART 6 – STRUCTURES GENERAL ARRANGEMENTS		
HE551478-SKAG-SBR-SECT1_B02N-DR-CB-26001	Structures General arrangements – Sheet 1 of 12	C03
HE551478-SKAG-SBR-SECT1_B03N-DR-CB-26001	Structures General arrangements – Sheet 2 of 12	C03

HE551478-SKAG-SBR-SECT1_B04N-DR-CB-26001	Structures General arrangements – Sheet 3 of 12	C03
HE551478-SKAG-SBR-SECT1_B05N-DR-CB-26001	Structures General arrangements – Sheet 4 of 12	C03
HE551478-SKAG-SBR-SECT1_B06N-DR-CB-26001	Structures General arrangements – Sheet 5 of 12	C03
HE551478-SKAG-SBR-SECT1_B07E-DR-CB-26001	Structures General arrangements – Sheet 6 of 12	C03
HE551478-SKAG-SBR-SECT1_B08N-DR-CB-26001	Structures General arrangements – Sheet 7 of 12	C03
HE551478-SKAG-SBR-SECT1_B09N-DR-CB-26001	Structures General arrangements – Sheet 8 of 12	C03
HE551478-SKAG-SBR-SECT1_B09N-DR-CB-26002	Structures General arrangements – Sheet 9 of 12	C02
HE551478-SKAG-SBR-SECT1_B11N-DR-CB-26001	Structures General arrangements – Sheet 10 of 12	C03
HE551478-SKAG-SBR-SECT1_B13N-DR-CB-26001	Structures General arrangements – Sheet 11 of 12	C03
HE551478-SKAG-SBR-SECT1_B17N-DR-CB-26001	Structures General arrangements – Sheet 12 of 12	C03



NOTES
 1. THE PURPOSE OF THIS DRAWING IS TO SUPPORT THE A46 NEWARK BYPASS DEVELOPMENT CONSENT ORDER (DCO) AND ACCOMPANYING APPLICATION DOCUMENTATION. (TR010065/APP/3.1).

KEY:
 — ORDER LIMITS
 — DESIGN LAYOUT
 ■ LAND NOT INCLUDED IN ORDER LIMITS
 (F) CROSS SECTION LOCATION

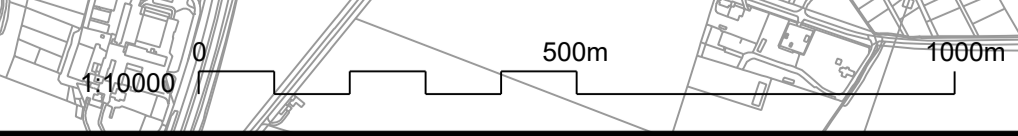

CO2	11/03/24	Revised for DCO Submission	JK	SC	HF
REV.	DATE	AMENDMENT DETAILS	ORIG	CHK'D	APP'D

CLIENT

PURPOSE OF ISSUE
 DCO APPLICATION

DEVELOPMENT CONSENT ORDER NUMBER
 TR010065

PROJECT TITLE
 A46 NEWARK BYPASS

DRAWING TITLE
 ENGINEERING PLANS AND SECTIONS
 REGULATION 5(2)(o), 5(2)(P) and 6(2)
 TYPICAL CROSS SECTIONS – KEY PLAN

ORIGINAL SIZE	A1	SCALE	1:10000	PROJECT REF NO.	HE551478
DRAWING NUMBER	ORIGINATOR	VOLUME		REVISION	
HE551478	SKAG	HGN			
CONWI_CONW	DR	CH	26100		
LOCATION	TYPE	ROLE	NUMBER		

This document is issued for the party which commissioned it and for specific purposes connected with the captioned project only. It should not be relied upon by any other party or used for any other purpose. We accept no responsibility for the consequences of this document being relied upon by any other party, or being used for any other purpose, or containing any error or omission which is due to an error or omission in data supplied to us by other parties.

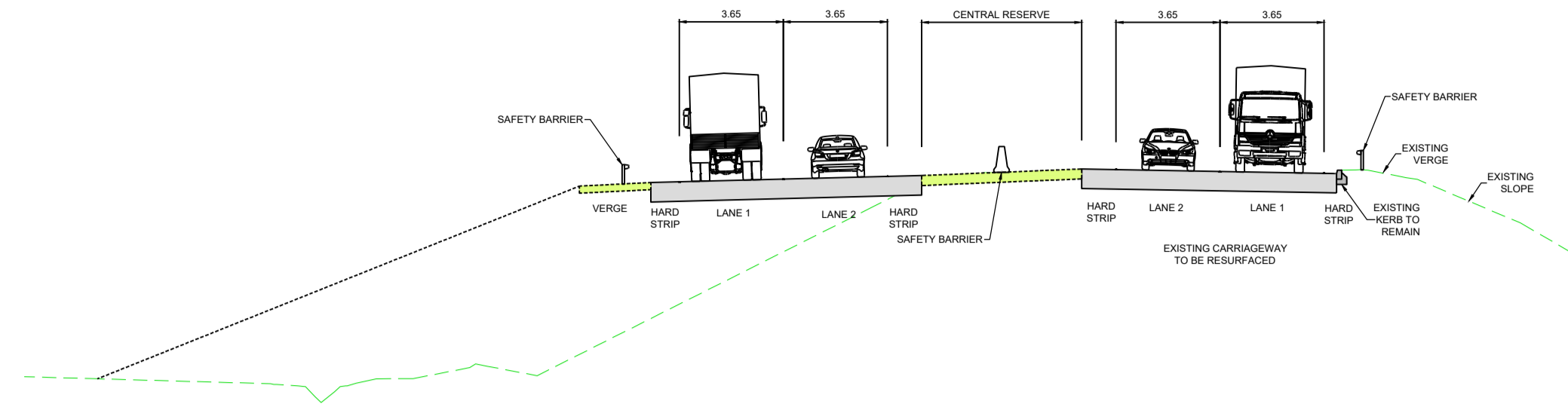

CROSS SECTION A
DUAL CARRIAGEWAY TO THE SOUTH OF WINDMILL VIADUCT

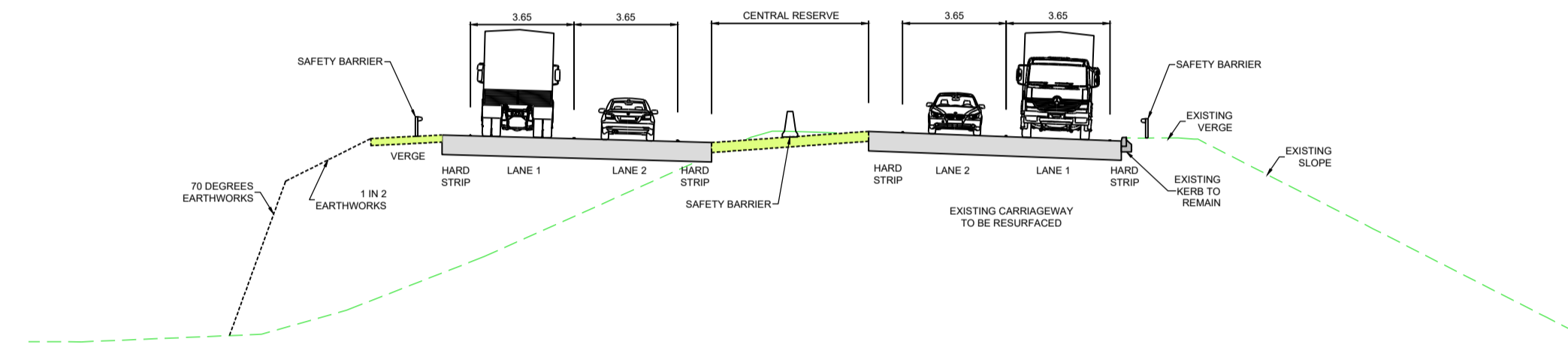

CROSS SECTION B
DUAL CARRIAGEWAY TO THE NORTH OF WINDMILL VIADUCT

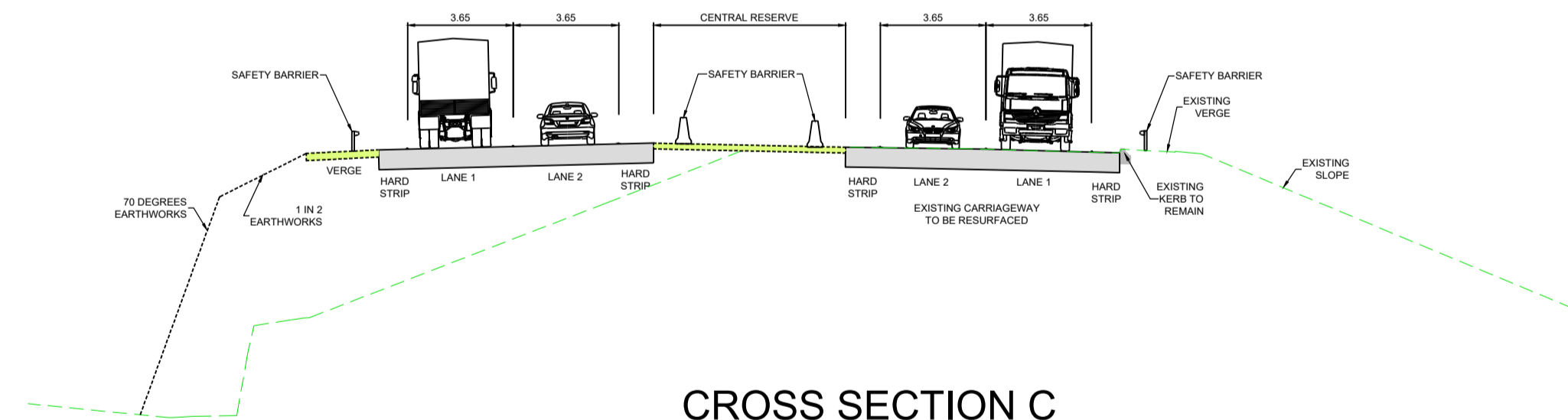

CROSS SECTION C
DUAL CARRIAGEWAY TO THE SOUTH OF THE NOTTINGHAM TO LINCOLN RAILWAY LINE WEST CROSSING

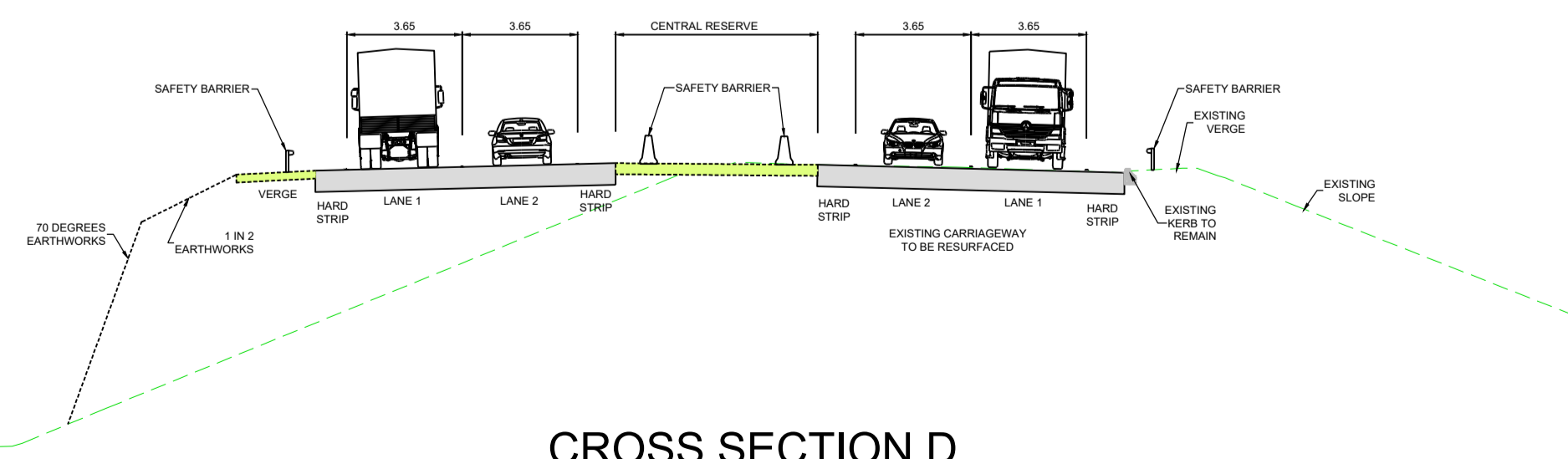

CROSS SECTION D
DUAL CARRIAGEWAY TO THE NORTH OF THE NOTTINGHAM TO LINCOLN RAILWAY LINE WEST CROSSING

NOTES

1. ALL DIMENSIONS ARE IN METRES UNLESS OTHERWISE STATED.
2. DO NOT SCALE FROM THIS DRAWING. USE ONLY PRINTED DIMENSIONS.
3. THE DIMENSIONS AND CROSS SECTIONS SHOWN ON THIS DRAWING ARE TYPICAL AND WILL VARY ACCORDING TO LOCATION.
4. THIS DRAWING SHOULD BE READ IN CONJUNCTION WITH ALL OTHER DOCUMENTS SUBMITTED AS PART OF THE DEVELOPMENT CONSENT ORDER (TR010065/APP).
5. FOR CARRIAGEWAY LEVELS PLEASE REFER TO THE PLAN AND PROFILE DRAWINGS (TR010065/APP/2.6).
6. THE DESIGN SHOWN WILL BE SUBJECT TO DETAILED DESIGN DEVELOPMENT IN ACCORDANCE WITH THE PROVISIONS OF THE DEVELOPMENT CONSENT ORDER (TR010065/APP/3.1).

KEY:

- EXISTING GROUND
- PAVEMENT
- FOOTWAY/ CYCLEWAY
- VERGE / CENTRAL RESERVE
- DESIGN LAYOUT
- EARTHWORKS

C02	11/03/24	Revised for DCO Submission	JK	SC	HF
REV.	DATE	AMENDMENT DETAILS	ORIG	CHK'D	APP'D

CLIENT

PURPOSE OF ISSUE: **DCO APPLICATION**

DEVELOPMENT CONSENT ORDER NUMBER: **TR010065**

PROJECT TITLE: **A46 NEWARK BYPASS**

DRAWING TITLE: **ENGINEERING PLANS AND SECTIONS
REGULATION 5(2)(a), 5(2)(P) and 6(2)
TYPICAL CROSS SECTIONS - SHEET 1 OF 4**

ORIGINAL SIZE: A1	SCALE: 1:200	PROJECT REF NO.: HE551478
DRAWING NUMBER: HE551478	ORIGINATOR: SKAG	VOLUME: HGN
LOCATION: CONWI_CONW	DR: DR	CH: CH
	TYPE: DR	ROLE: CH
	NUMBER: 26106	REVISION: C02

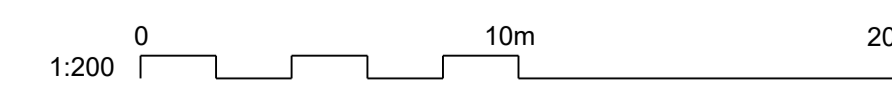

100
90
80
70
60
50
40
30
20
10

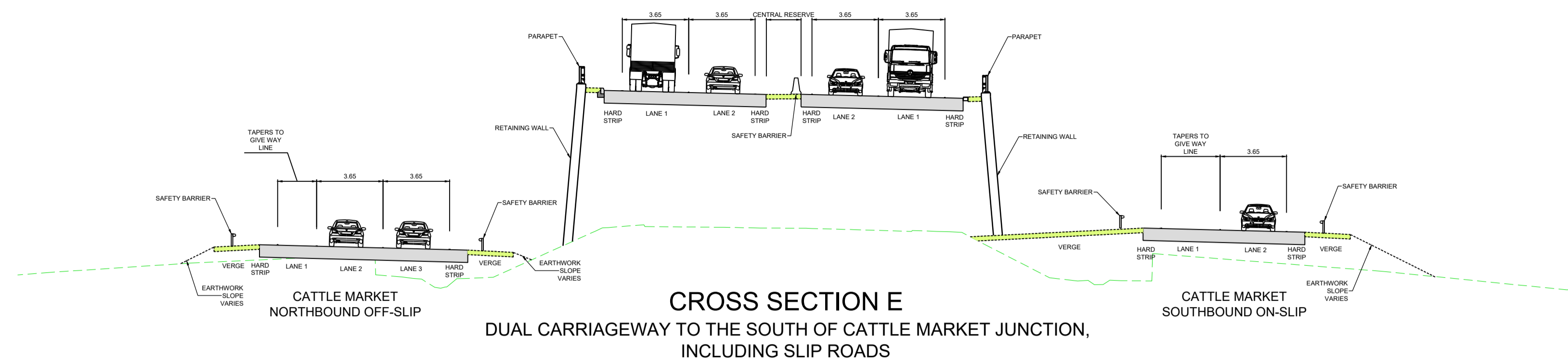

CROSS SECTION E
DUAL CARRIAGEWAY TO THE SOUTH OF CATTLE MARKET JUNCTION,
INCLUDING SLIP ROADS

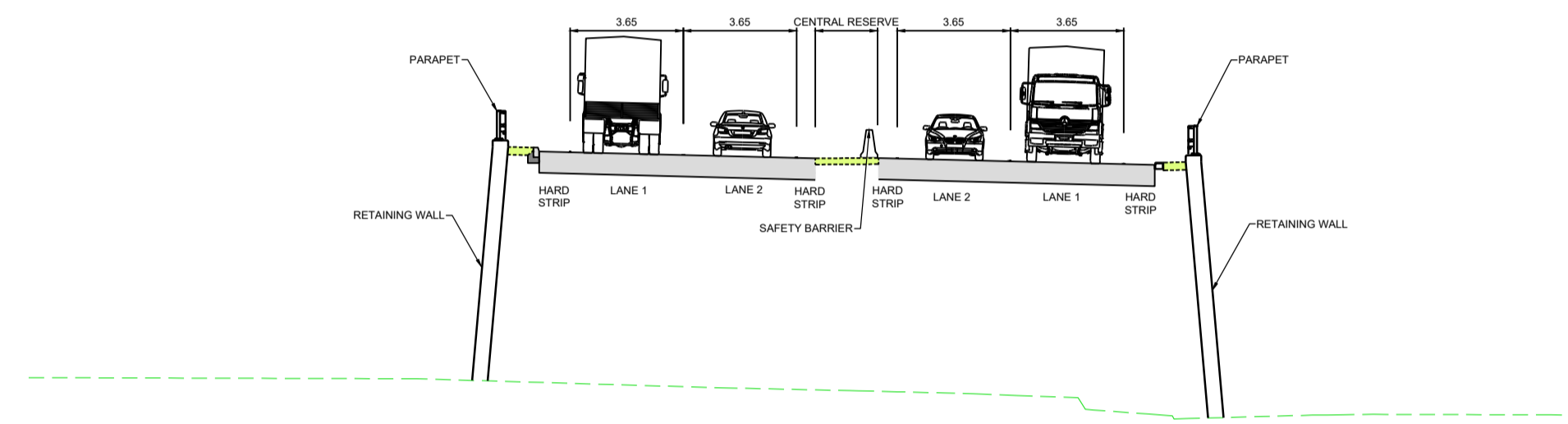

CROSS SECTION F
DUAL CARRIAGEWAY AT CATTLE MARKET JUNCTION

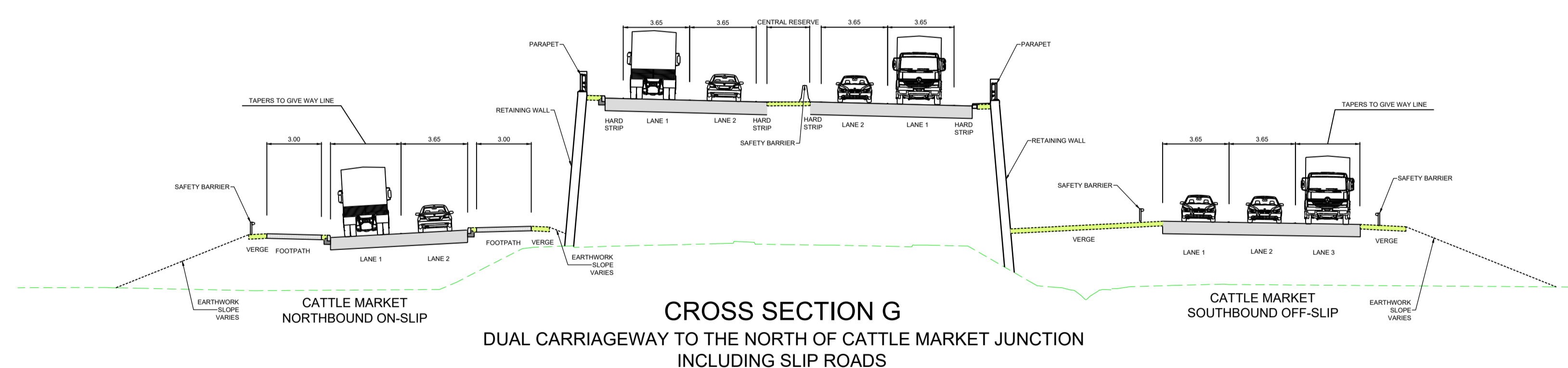

CROSS SECTION G
DUAL CARRIAGEWAY TO THE NORTH OF CATTLE MARKET JUNCTION
INCLUDING SLIP ROADS

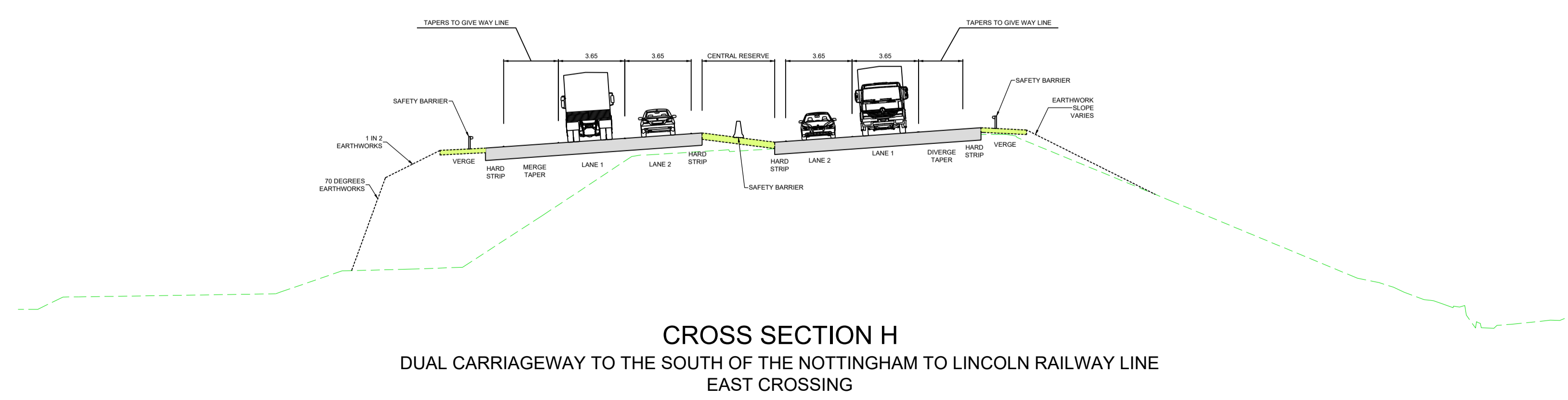

CROSS SECTION H
DUAL CARRIAGEWAY TO THE SOUTH OF THE NOTTINGHAM TO LINCOLN RAILWAY LINE
EAST CROSSING

- NOTES**
1. ALL DIMENSIONS ARE IN METRES UNLESS OTHERWISE STATED.
 2. DO NOT SCALE FROM THIS DRAWING. USE ONLY PRINTED DIMENSIONS.
 3. THE DIMENSIONS AND CROSS SECTIONS SHOWN ON THIS DRAWING ARE TYPICAL AND WILL VARY ACCORDING TO LOCATION.
 4. THIS DRAWING SHOULD BE READ IN CONJUNCTION WITH ALL OTHER DOCUMENTS SUBMITTED AS PART OF THE DEVELOPMENT CONSENT ORDER (TR010065/APP).
 5. FOR CARRIAGEWAY LEVELS PLEASE REFER TO THE PLAN AND PROFILE DRAWINGS (TR010065/APP/2.6).
 6. THE DESIGN SHOWN WILL BE SUBJECT TO DETAILED DESIGN DEVELOPMENT IN ACCORDANCE WITH THE PROVISIONS OF THE DEVELOPMENT CONSENT ORDER (TR010065/APP/3.1).

KEY:

	EXISTING GROUND
	PAVEMENT
	FOOTWAY/ CYCLEWAY
	VERGE / CENTRAL RESERVE
	DESIGN LAYOUT
	EARTHWORKS

C02	11/03/24	Revised for DCO Submission	JK	SC	HF
REV.	DATE	AMENDMENT DETAILS	ORIG	CHK'D	APP'D

CLIENT

PURPOSE OF ISSUE
DCO APPLICATION

DEVELOPMENT CONSENT ORDER NUMBER
TR010065

PROJECT TITLE
A46 NEWARK BYPASS

DRAWING TITLE
ENGINEERING PLANS AND SECTIONS
REGULATION 5(2)(a), 5(2)(P) and 6(2)
TYPICAL CROSS SECTIONS - SHEET 2 OF 4

ORIGINAL SIZE	A1	SCALE	1:200
---------------	----	-------	-------

DRAWING NUMBER	ORIGINATOR	VOLUME	PROJECT REF NO.
HE551478	SKAG	HGN	HE551478
CONWI_CONW	DR	CH	REVISION
LOCATION	TYPE	ROLE	NUMBER
			C02

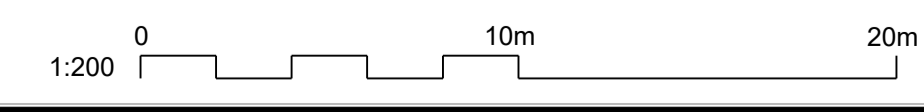

100
90
80
70
60
50
40
30
20
10
0

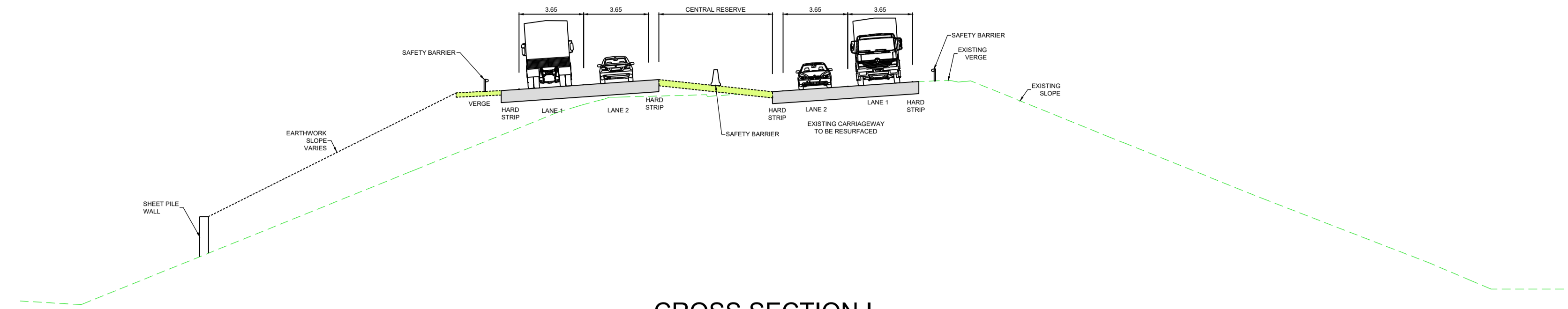

CROSS SECTION I
DUAL CARRIAGEWAY TO THE NORTH OF THE NOTTINGHAM TO LINCOLN RAILWAY LINE
EAST CROSSING

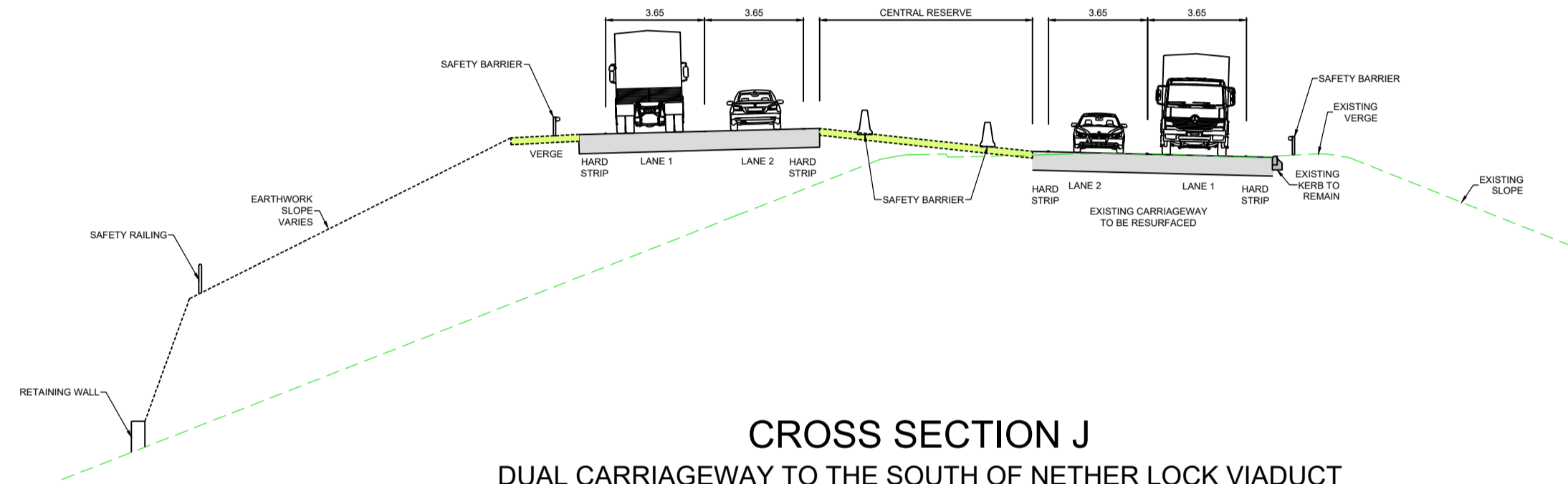

CROSS SECTION J
DUAL CARRIAGEWAY TO THE SOUTH OF NETHER LOCK VIADUCT

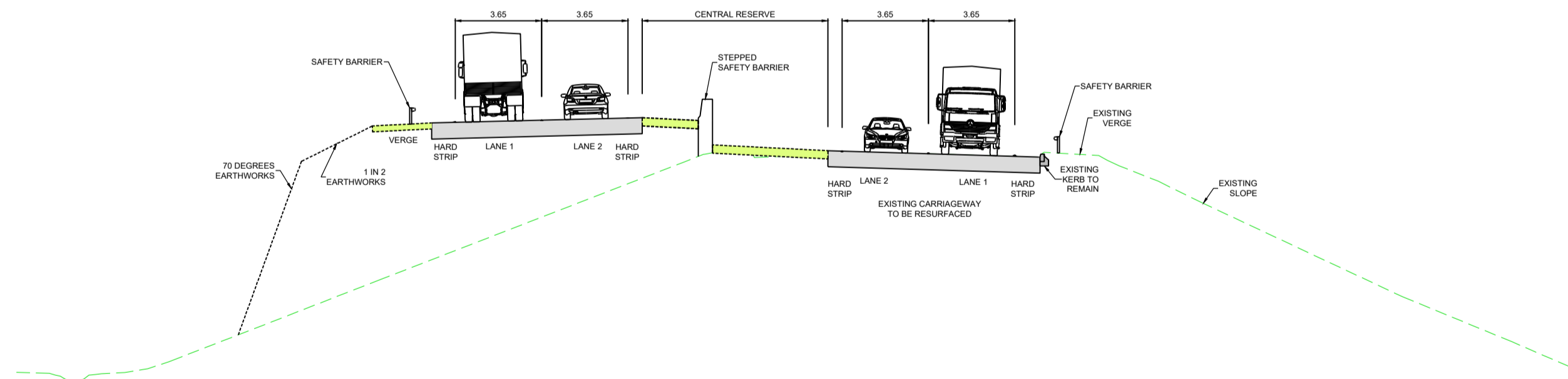

CROSS SECTION K
DUAL CARRIAGEWAY TO THE NORTH OF NETHER LOCK VIADUCT

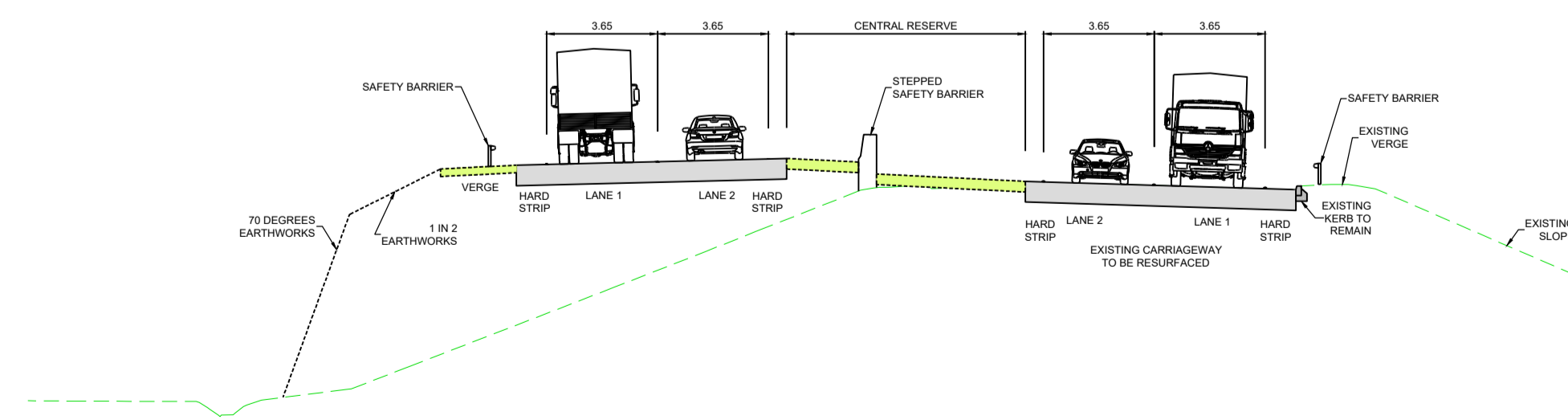

CROSS SECTION L
DUAL CARRIAGEWAY TO THE NORTH OF THE
SEWAGE WORKS UNDERBRIDGE

NOTES

1. ALL DIMENSIONS ARE IN METRES UNLESS OTHERWISE STATED.
2. DO NOT SCALE FROM THIS DRAWING. USE ONLY PRINTED DIMENSIONS.
3. THE DIMENSIONS AND CROSS SECTIONS SHOWN ON THIS DRAWING ARE TYPICAL AND WILL VARY ACCORDING TO LOCATION.
4. THIS DRAWING SHOULD BE READ IN CONJUNCTION WITH ALL OTHER DOCUMENTS SUBMITTED AS PART OF THE DEVELOPMENT CONSENT ORDER (TR010065/APP).
5. FOR CARRIAGEWAY LEVELS PLEASE REFER TO THE PLAN AND PROFILE DRAWINGS (TR010065/APP/2.6).
6. THE DESIGN SHOWN WILL BE SUBJECT TO DETAILED DESIGN DEVELOPMENT IN ACCORDANCE WITH THE PROVISIONS OF THE DEVELOPMENT CONSENT ORDER (TR010065/APP/3.1).

KEY:

- EXISTING GROUND
- PAVEMENT
- FOOTWAY/ CYCLEWAY
- VERGE / CENTRAL RESERVE
- DESIGN LAYOUT
- EARTHWORKS

C02	11/03/24	Revised for DCO Submission	JK	SC	HF
REV.	DATE	AMENDMENT DETAILS	ORIG	CHK'D	APP'D

CLIENT



PURPOSE OF ISSUE: **DCO APPLICATION**

DEVELOPMENT CONSENT ORDER NUMBER: **TR010065**

PROJECT TITLE: **A46 NEWARK BYPASS**

DRAWING TITLE: **ENGINEERING PLANS AND SECTIONS
REGULATION 5(2)(a), 5(2)(P) and 6(2)
TYPICAL CROSS SECTIONS - SHEET 3 OF 4**

ORIGINAL SIZE	A1	SCALE	1:200
---------------	----	-------	-------

DRAWING NUMBER	ORIGINATOR	VOLUME	PROJECT REF NO.
HE PIN			HE551478
HE551478	SKAG	HGN	
CONWI_CONW	DR	CH	REVISION
LOCATION	TYPE	ROLE	NUMBER
			C02

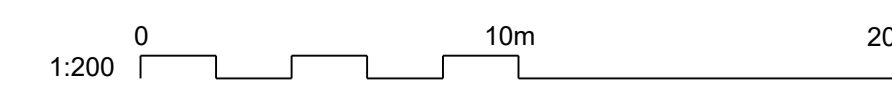

100
90
80
70
60
50
40
30
20
10
0

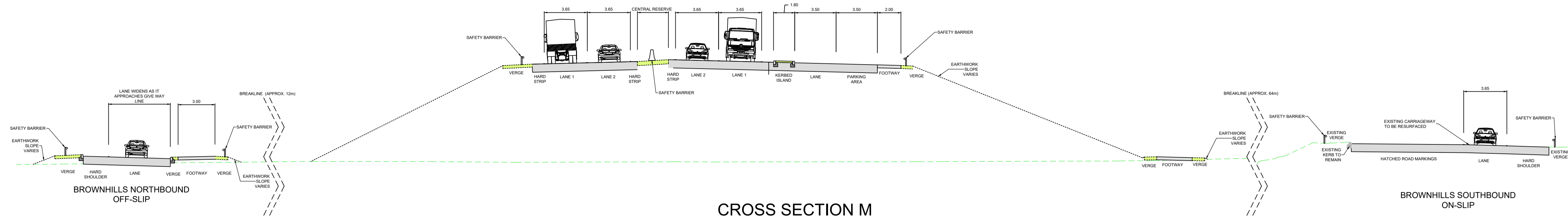

CROSS SECTION M
DUAL CARRIAGEWAY TO THE SOUTH OF BROWNHILLS UNDERBRIDGE (INCLUDING PARKING LAY-BY)

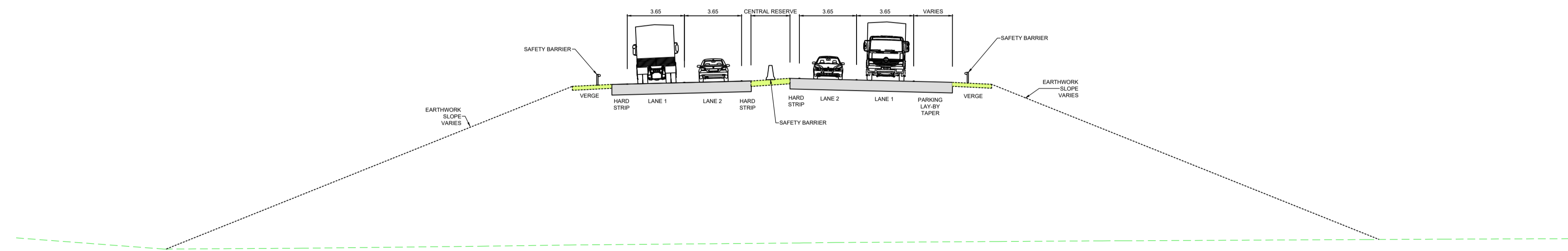

CROSS SECTION N
DUAL CARRIAGEWAY BETWEEN BROWNHILLS UNDERBRIDGE AND THE A1 CROSSING

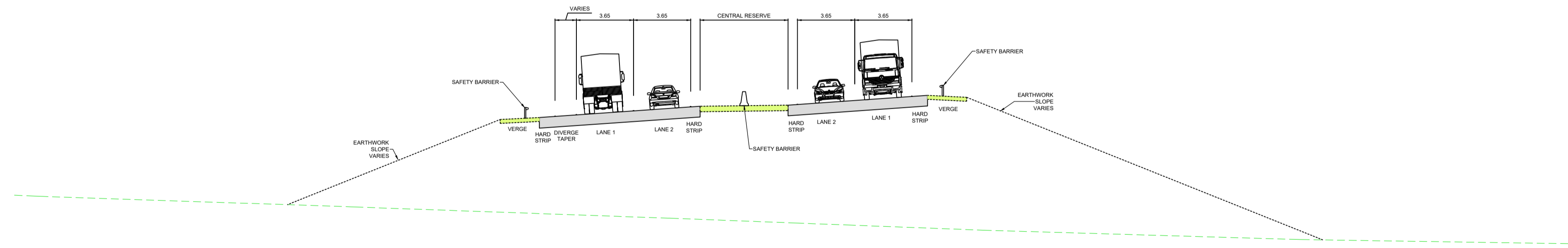

CROSS SECTION O
DUAL CARRIAGEWAY TO THE NORTH OF THE A1 CROSSING

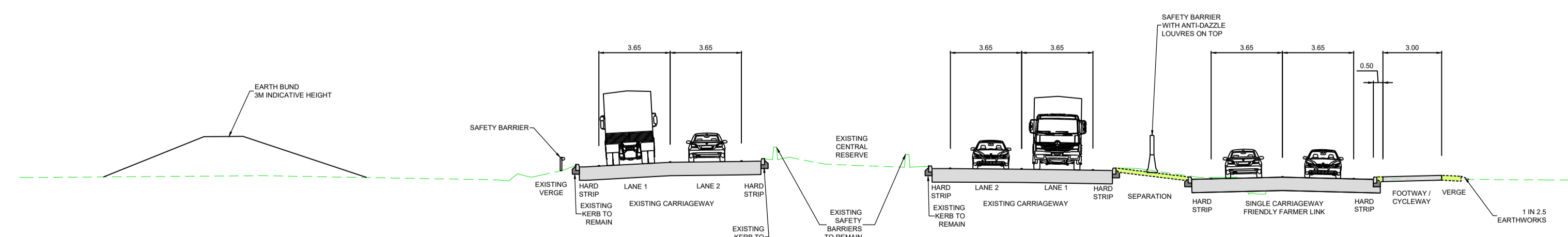

CROSS SECTION P
DUAL CARRIAGEWAY, FRIENDLY FARMER LINK AND EARTHWORK BUND BETWEEN THE A1 AND WINTHORPE ROUNDABOUT

NOTES

1. ALL DIMENSIONS ARE IN METRES UNLESS OTHERWISE STATED.
2. DO NOT SCALE FROM THIS DRAWING. USE ONLY PRINTED DIMENSIONS.
3. THE DIMENSIONS AND CROSS SECTIONS SHOWN ON THIS DRAWING ARE TYPICAL AND WILL VARY ACCORDING TO LOCATION.
4. THIS DRAWING SHOULD BE READ IN CONJUNCTION WITH ALL OTHER DOCUMENTS SUBMITTED AS PART OF THE DEVELOPMENT CONSENT ORDER (TR010065/APP).
5. FOR CARRIAGEWAY LEVELS PLEASE REFER TO THE PLAN AND PROFILE DRAWINGS (TR010065/APP/2.6).
6. THE DESIGN SHOWN WILL BE SUBJECT TO DETAILED DESIGN DEVELOPMENT IN ACCORDANCE WITH THE PROVISIONS OF THE DEVELOPMENT CONSENT ORDER (TR010065/APP/3.1).

KEY:

- EXISTING GROUND
- PAVEMENT
- FOOTWAY/ CYCLEWAY
- VERGE / CENTRAL RESERVE
- DESIGN LAYOUT
- EARTHWORKS

C02	11/03/24	Revised for DCO Submission	JK	SC	HF
REV.	DATE	AMENDMENT DETAILS	ORIG	CHK'D	APP'D

CLIENT

PURPOSE OF ISSUE
DCO APPLICATION

DEVELOPMENT CONSENT ORDER NUMBER
TR010065

PROJECT TITLE
A46 NEWARK BYPASS

DRAWING TITLE
ENGINEERING PLANS AND SECTIONS
REGULATION 5(2)(o), 5(2)(P) and 6(2)
TYPICAL CROSS SECTIONS - SHEET 4 OF 4

ORIGINAL SIZE	A1	SCALE	1:200
---------------	----	-------	-------

DRAWING NUMBER	ORIGINATOR	VOLUME	PROJECT REF NO.
HE PIN			HE551478
HE551478	SKAG	HGN	
CONWI_CONW	DR	CH	REVISION
LOCATION	TYPE	ROLE	NUMBER
			C02

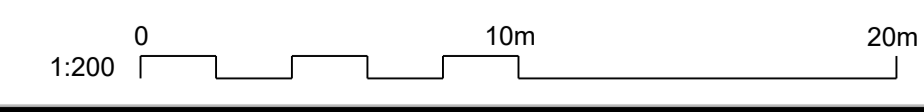

100
90
80
70
60
50
40
30
20
10